

52 HRC

Genel Kullanım

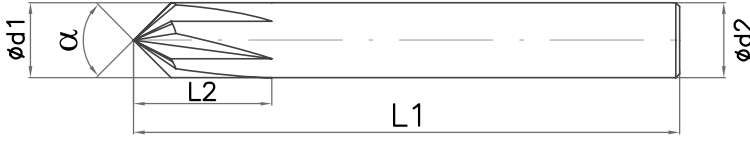

Şaft Toleransı h6
Mikrograin ISO:K10/20
Pah Açma Freze

Genel Mühendislik • Kalıpcılık • Otomotiv • Savunma Sanayi

| Ø d1 | L2 | L1 | Ø d2 | Z | α=60° | α=90° |
|------|----|----|------|---|----------------|----------------|
| 6 | 15 | 58 | 6 | 4 | SFH1121-060060 | SFH1121-060090 |
| 8 | 15 | 64 | 8 | 5 | SFH1121-080060 | SFH1121-080090 |
| 10 | 21 | 73 | 10 | 6 | SFH1121-100060 | SFH1121-100090 |
| 12 | 25 | 84 | 12 | 6 | SFH1121-120060 | SFH1121-120090 |



Karbür Havşa Freze Genel Kullanım

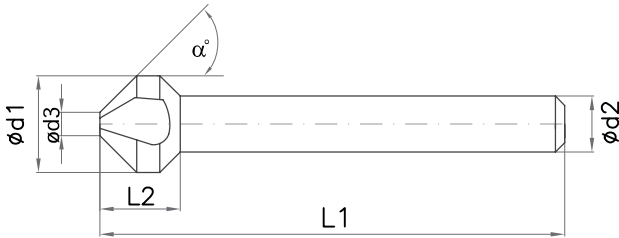

Şaft Toleransı h6
Mikrograin ISO:K10/20



| Ø d1 | L2 | Ø d3 | L1 | Ø d2 | Z | α=60° | α=90° | α=120° |
|------|------|------|----|------|---|----------------|----------------|-----------------|
| 6,3 | 2,15 | 2 | 45 | 5 | 3 | SFH1123-603060 | SFH1123-603090 | SFH1123-6030120 |
| 8,3 | 3,15 | 2 | 50 | 6 | 3 | SFH1123-803060 | SFH1123-803090 | SFH1123-8030120 |
| 10,4 | 3,95 | 2,5 | 50 | 6 | 3 | SFH1123-104060 | SFH1123-104090 | SFH1123-1040120 |
| 12,4 | 4,8 | 2,8 | 56 | 8 | 3 | SFH1123-124060 | SFH1123-124090 | SFH1123-1240120 |
| 15,0 | 5,9 | 3,2 | 60 | 10 | 3 | SFH1123-150060 | SFH1123-150090 | SFH1123-1500120 |
| 16,5 | 6,65 | 3,2 | 60 | 10 | 3 | SFH1123-165060 | SFH1123-165090 | SFH1123-1650120 |
| 20,5 | 8,5 | 3,5 | 63 | 10 | 3 | SFH1123-205060 | SFH1123-205090 | SFH1123-2050120 |
| 25,0 | 10,6 | 3,8 | 67 | 10 | 3 | SFH1123-250060 | SFH1123-250090 | SFH1123-2500120 |
| 31,0 | 12,2 | 4,2 | 71 | 12 | 3 | SFH1123-310060 | SFH1123-310090 | SFH1123-3100120 |